

2 3/8" DIA.
GALVANIZED
STEEL POST
.065" WALL

STOP SIGN TO BE SET
BEHIND ACCESSIBLE PATHWAY

24" SOLID WHITE STRIPE
(12" MIN. IF PROJECT
RESTRAINTS PREVENT 24")

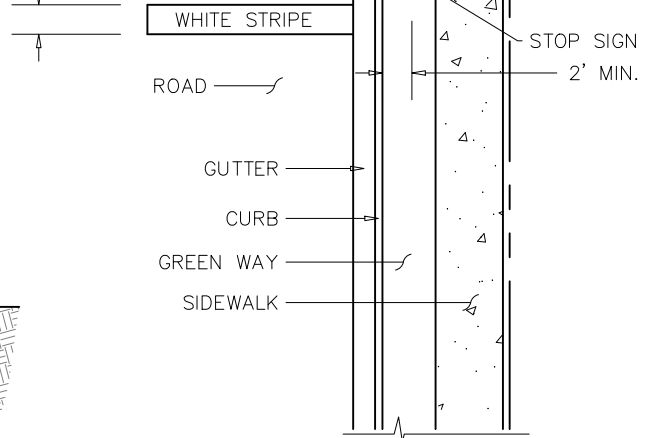

POZ LOC SOCKET AND WEDGE IS
EXPOSED AT GROUND. NOT TO
EXCEED 2 INCHES ABOVE GRADE.

27" POZ LOC
SOCKET
& WEDGE

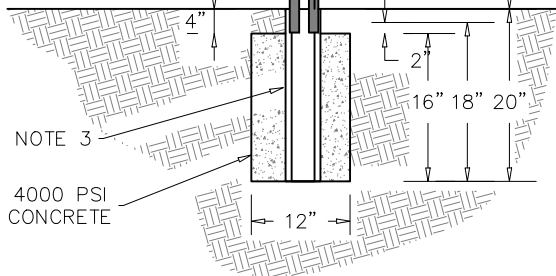

NOTE 3

4000 PSI
CONCRETE

NOTES:

1. SIGNS ON STATE FACILITIES SHALL CONFORM TO TXDOT STANDARDS.
2. DISTANCE FROM THE EDGE OF THE STREET POST TO THE FACE OF THE CURB SHALL BE A MINIMUM OF 2'.
3. SLEEVE WILL BE 18" GALVANIZED STEEL PIPE WITH O.D. 2 7/8" AND I.D. 2 5/8"

SHT 1 OF 2



It's real.

DATE ISSUED:	DECEMBER 18, 2018		
REVISION	DATE	BY	
1ST REVISION	1/28/19	MS	
2ND REVISION	10/16/20	MS	

TITLE	STREET SIGN INSTALLATION DETAIL		
-------	------------------------------------	--	--

SCALE:	DRAWING No.
N.T.S.	RDWY-11.1